

# Sparepart drawing Class 128 Chassis W1

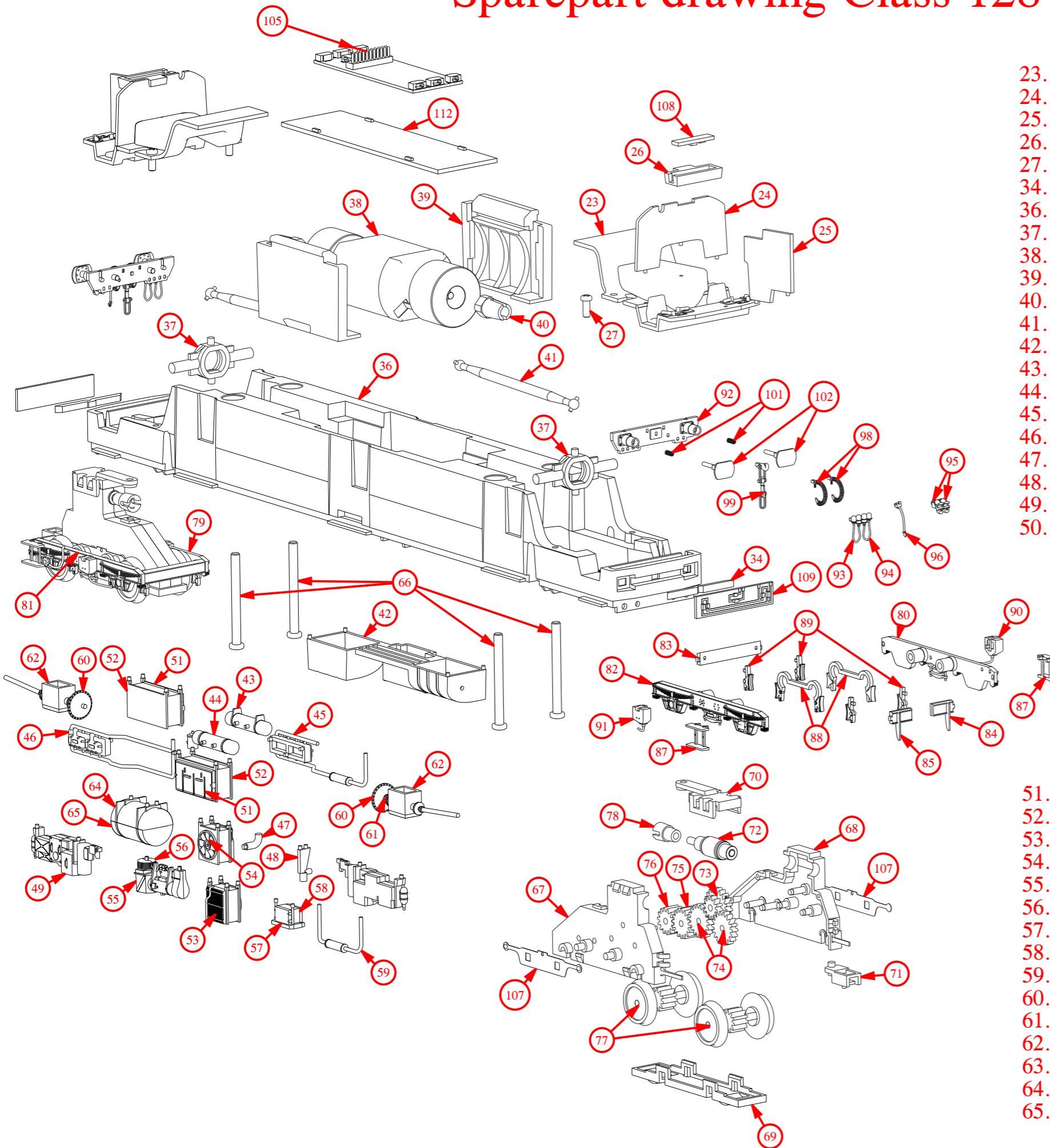

- |     |                              |      |                                 |
|-----|------------------------------|------|---------------------------------|
| 23. | Interior                     | 66.  | Screw 2.5x28 Body Chassis       |
| 24. | Back wall                    | 67.  | Gearbox right                   |
| 25. | Wall divider                 | 68.  | Gearbox left                    |
| 26. | Holder for LED drivers cabin | 69.  | Gearbox bottom                  |
| 27. | Screw for interior           | 70.  | Gearbox top                     |
| 34. | Light guide (W1-version)     | 71.  | NEM socket                      |
| 36. | Chassis                      | 72.  | Worm gear w.shaft and bearings  |
| 37. | Suspension bridge            | 73.  | Spur gear Z20 - Z12             |
| 38. | Motor w. flywheel            | 74.  | Pinion gear Z18                 |
| 39. | Motorfastner (evoprene)      | 75.  | Pinion gear Z16                 |
| 40. | Cardan- motor                | 76.  | Pinion gear Z14                 |
| 41. | Shaft for Cardan             | 77.  | Axle w. wheel and 12Z pinion    |
| 42. | Engine box                   | 78.  | Cardan join gearbox             |
| 43. | Air tank top                 | 79.  | Bogie original                  |
| 44. | Air tank bottom              | 80.  | Bogie Back                      |
| 45. | Engine side front            | 81.  | Bogie w. speedometer            |
| 46. | Engine side back             | 82.  | Bogie w. mileometer             |
| 47. | Pipe 90 degree front         | 83.  | Back beam for bogie             |
| 48. | Detail 1 engine              | 84.  | Bogie lifeguard right           |
| 49. | Detail 2 engine              | 85.  | Bogie lifeguard left            |
| 50. | Detail 2 back                | 86.  | Speedometer for bogie           |
|     |                              | 87.  | Step on bogie right             |
|     |                              | 88.  | Brakes                          |
|     |                              | 89.  | Brakes on lifeguard             |
|     |                              | 90.  | Sand box for bogie right        |
|     |                              | 91.  | Sand box for bogie left         |
|     |                              | 92.  | Bufferbeam                      |
|     |                              | 93.  | MU Jumper with cable left       |
|     |                              | 94.  | MU Jumper with cable right      |
|     |                              | 95.  | MU Jumper receptacle            |
|     |                              | 96.  | Pinion gear Z14                 |
|     |                              | 98.  | Vaccum pipe                     |
|     |                              | 99.  | Screw couplerl                  |
|     |                              | 101. | Buffer Spring                   |
|     |                              | 105. | PCB 21 pin w. connectors        |
|     |                              | 107. | Contact wipers w. wire and plug |
|     |                              | 108. | PCB w. smd led (interior)       |
|     |                              | 109. | PCB for Headcode light          |
|     |                              | 111. | Bolt 2.5 mm.                    |
|     |                              | 112. | Holder for PCB                  |
| 51. | Big battery box              |      |                                 |
| 52. | Big battery box back         |      |                                 |
| 53. | Radiator box                 |      |                                 |
| 54. | Radiator box back            |      |                                 |
| 55. | Heater unit                  |      |                                 |
| 56. | Heater unit back             |      |                                 |
| 57. | Small battery box            |      |                                 |
| 58. | Small battery box back       |      |                                 |
| 59. | Heat pipe back               |      |                                 |
| 60. | Bell housing right           |      |                                 |
| 61. | Bell housing left            |      |                                 |
| 62. | Gearbox driving shaft        |      |                                 |
| 63. | Gearbox little bottom        |      |                                 |
| 64. | Big tank top part            |      |                                 |
| 65. | Big tank bottom part         |      |                                 |